

# Rubber inserts of pinch valves – not drilled flanges DN24 – DN150

METAL-GUM Zielona Góra ul. Naftowa 2, tel. (68) 458-55-60, bok@metal-gum.com.pl

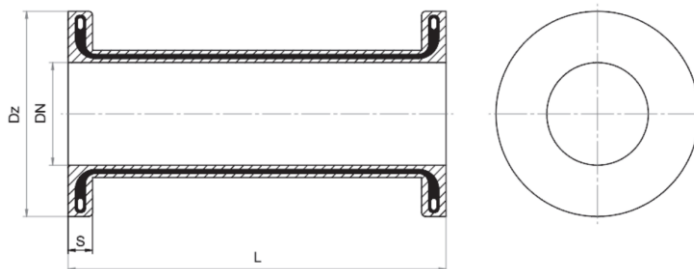

**Technical datas:**

- range diameters: DN24-DN150
- working pressure: 0,6/1,0/1,6 MPa
- working temperature: max. 100°C  
temperature depends on kind of rubber and working pressure
- No flange openings

**Construction:**

- Inner lining: NR, EPDM, EPDM-HT, SBR, NBR
- Reinforced with a syntetic cord

**Advantages::**

- durability and reliability of using
- certified rubber compounds

- Compliance with the pressure directive 2014/68 / EU makes that the fittings are safe in use.

## Dimension Table

DN	L (mm)	Flange openings PN	Max Working pressure (MPa)	Dz	s
24	108	Brak	1,6	59	12
25	165	Brak	1,6	61	10
32	164	Brak	1,6	68	10
40	164	Brak	1,6	78	10
50	160	Brak	1,6	100	12
50	162	Brak	1,6	100	12
50	164	Brak	1,6	100	12
50	200	Brak	1,6	100	12
65	164	Brak	1,6	114	12
65	165	Brak	1,6	114	12
65	166	Brak	1,6	114	11
65	166	Brak	1,6	114	12
65	200	Brak	1,6	114	12
80	200	Brak	1,6	131	12
100	252	Brak	1,6	152	12,5
125	310	Brak	1,6	182	15
150	373	Brak	1,6	208	16

Parameters beyond those indicated above e.g. increased range of working pressure or other diameters - on individual customer's request

Every rubber insert can have opening tags

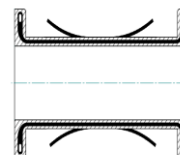

**We also produce:**