

Description:

Expansion joints made in rubber technology are used to damp vibrations and compensate for displacements resulting from stress and thermal elongation of pipelines. It has the ability to be highly compensated, especially in angular directions. In addition, the bellows have textile reinforcements consisting of several layers, which ensures durability in difficult working conditions. Due to the material from which the flanges are made, the compensator is characterized by lower weight and easier assembly.

CERTIFICATES



Motion compensation



Axial (elongines)
(+ ◀▶)



Axial (compression)
(- ▶▶)



Angular
(± α°)



Radial
(± ▲▼)

Technical Datas:

- Range of diameter: DN50-DN300
- max. working temperatures from -20°C up +70°C
- max. working pressure 0,6 MPa
- flange openings: PN6, PN10

Construction:

- bellow:
Guma EPDM, NBR, NR, SBR, CSM
- flanges:
Artificial (plastic) material PA

DN	BL [mm]	ØA [mm]	pow. czynna [cm ²]	ØD [mm]	Flangers PN 6				Motion compensation			
					PC [mm]	Ød [mm]	n	s [mm]	axial		lateral	alfa
									-mm	+ mm	± mm	±
50	130	96	32	140	110	14	4	26	20	20	20	12
65	130	111	53	160	130	14	4	26	20	20	20	12
80	130	122	85	190	150	18	4	26	20	20	20	10
100	130	142	128	210	170	18	4	28	20	20	20	10
125	130	168	187	240	200	18	8	28	20	20	20	8
150	130	192	259	265	225	18	8	28	20	20	20	6
200	130	252	410	320	280	18	8	30	15	15	15	5
250	130	302	596	375	335	18	12	30	15	15	15	5
300	130	354	822	440	395	22	12	30	15	15	15	5

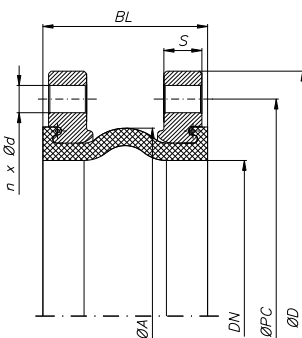

- BL – bellow length
- ØA – bellow diameter
- ØD – external flange diameter
- ØPC – opening pitch diameter
- Ød – screw holes diameter
- n – number of screw holes
- s – flange thickness

DN	BL [mm]	ØA [mm]	pow. czynna [cm ²]	ØD [mm]	Flangers PN 10				Motion compensation			
					PC [mm]	Ød [mm]	n	s [mm]	axial		lateral	alfa
									-mm	+mm	±mm	±
50	130	96	32	165	125	18	4	26	20	20	20	12
65	130	111	53	185	145	18	8	26	20	20	20	12
80	130	122	85	200	160	18	8	26	20	20	20	10
100	130	142	128	220	180	18	8	28	20	20	20	10
125	130	168	187	250	210	18	8	28	20	20	20	8
150	130	192	259	285	240	22	8	28	20	20	20	6
200	130	252	410	340	295	22	8	30	15	15	15	5
250	130	302	596	395	350	22	12	30	15	15	15	5
300	130	354	822	445	400	22	12	30	15	15	15	5

* the above diameters and building length are standard - it is possible to place an order with individual values.

Auxiliary equipment:



Anti – fouling cover

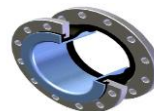

Deflector



Vacuum bellow