

Description:

KM type rubber compensators manufactured by METAL-GUM at a robotic production stand, have high technical qualities, among others:

- high flexibility
- high tear strength (thanks to the aramid cord)
- long working life
- high abrasion resistance
- reduced lead time

CERTIFICATES



Motion compensation



Axial (elongines)
(+ ◀▶)



Axial (compression)
(- ▶◀)



Angular
(± α°)



Radial
(± ▲▼)

Technical datas:

- range od diameter: DN100-DN1200
- working pressure: 0,6 MPa, 1,0 MPa, 16 MPa
- flange openings: PN6, PN10, PN16

Construction:

- bellow:
 - EPDM, NBR, SBR, CR, NR
 - Another kinds of rubber are also available on request (viton, silikon).
 - The color of the strap on the bellows depends on the type of rubber
- flange:
 - steel galvanized - coating Zn,
 - acid resistant steel, 1.4301, 1.4401, 1.4404, and others referring to the query

Flanges can be equipped with a lenght limiters (integratede with type 1 compensators flange or screwed to type 2 pipeline flange)

DN	BL [mm]	Bellow		Flanges PN 6					Flanges PN 10				
		ØA [mm]	Active surface [cm ²]	ØD [mm]	PC [mm]	Ød [mm]	n	s [mm]	ØD [mm]	PC [mm]	Ød [mm]	n	s [mm]
100	130	142	128	220	180	18	8	18	220	180	18	8	18
125	130	168	187	250	210	18	8	18	250	210	18	8	18
150	130	192	259	285	240	23	8	20	285	240	22	8	20
200	130	252	410	340	295	23	8	20	340	295	22	12	20
250	130	302	596	395	350	23	12	20	405	355	26	12	20
300	130	354	822	445	400	23	12	20	460	410	26	12	20
350	200	430	907	505	460	22	16	20	520	470	26	16	20
400	200	480	1018	565	515	26	16	30	580	525	30	16	25
500	200	580	1692	670	620	26	20	30	715	650	33	20	30
600	200	680	3078	780	725	30	20	30	840	770	36	20	30
700	250	800	4019	895	840	30	24	30	910	840	36	24	35
800	250	880	5436	1015	950	33	24	30	1025	950	39	24	40
1000	300	1080	8231	1230	1160	36	28	25	1255	1170	42	28	40
1200	350	1380	10102	1511	1380	39	32	35	1485	1390	48	36	40

DN	BL [mm]	Bellow		Flanges PN 16				
		ØA [mm]	Active surface [cm ²]	ØD [mm]	PC [mm]	Ød [mm]	n	s [mm]
100	130	142	128	220	180	18	8	18
125	130	168	187	250	210	18	8	18
150	130	192	259	285	240	23	8	20
200	130	252	410	340	295	23	8	20
250	130	302	596	395	350	23	12	20
300	130	354	822	445	400	23	12	20
350	200	430	907	505	460	22	16	20
400	200	480	1018	565	515	26	16	30
500	200	580	1692	670	620	26	20	30
600	200	680	3078	780	725	30	20	30
700	250	800	4019	895	840	30	24	30
800	250	880	5436	1015	950	33	24	30
1000	300	1080	8231	1230	1160	36	28	25
1200	350	1380	10102	1511	1380	39	32	35

DN	Motion compensation			
	axial		lateral	alfa
	-mm	+mm	±mm	±°
100	30	30	30	20
125	30	30	30	15
150	30	30	30	15
200	30	30	30	10
250	30	30	30	10
300	30	30	30	8
350	30	30	30	6
400	30	30	30	6
500	40	30	30	5
600	40	30	30	5
700	40	20	30	4
800	40	20	20	3
1000	20	20	20	3
1200	20	20	20	3

*above mentioned diameters and lenghts are in standard. Here is a possibility to perform a product in anothers dimensions , according to requirements

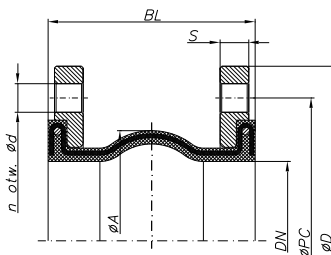

- BL – bellow lenght
- ØA – bellow diameter
- ØD – internal flange diameter
- ØPC – pitch diameter of the assembly openings
- Ød – screw holes diameter
- n – number of the holes in a flange
- s – flange thickness

Auxiliary equipment:



Anti – fouling cover

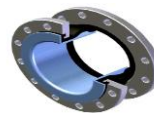

Deflector [KO]



Vacuum bellow